



OIL TRANSFER EQUIPMENT

Dispensing containers and colour-coded lids have been tried and proven in the toughest work environments.

**Durable, easy-to-use,
efficient and safe.**

Enluse B.V.
info@enluse.com
+31 765781280
+44 7393 429957

Storage Lid



OilSafe drums can be prefilled for storage or easier transportation with this lid. A convenient alternative to handling bulky 20 liter drums.

Part nr.	Color
100100	Beige
100101	Black
100102	Blue
100103	Dk Green
100104	Gray
100105	Mid Green
100106	Orange
100107	Purple
100108	Red
100109	Yellow

Mini Spout Lid



With an outlet diameter of approx. 7mm this mini spout is ideal for lubrication jobs where equipment filler holes are small.

Part nr.	Color
100400	Beige
100401	Black
100402	Blue
100403	Dk Green
100404	Gray
100405	Mid Green
100406	Orange
100407	Purple
100408	Red
100409	Yellow

Utility Lid



Multi purpose lid with large outlet hole ensures controlled fast pouring of lubricants. Match this lid to 3, 5 or 10 liter drum for use with OilSafe pump.

Part nr.	Color
100200	Beige
100201	Black
100202	Blue
100203	Dk Green
100204	Gray
100205	Mid Green
100206	Orange
100207	Purple
100208	Red
100209	Yellow

Stumpy Spout Lid



This wide spout model is especially designed for applications where a higher lubricant flow is required.

Part nr.	Color
100500	Beige
100501	Black
100502	Blue
100503	Dk Green
100504	Gray
100505	Mid Green
100506	Orange
100507	Purple
100508	Red
100509	Yellow

Stretch Lid



Designed for use where precise pouring of lubricants is required including hard to reach areas. Ideal for lower viscosity oils (<ISO 220).

Part nr.	Color
100300	Beige
100301	Black
100302	Blue
100303	Dk Green
100304	Gray
100305	Mid Green
100306	Orange
100307	Purple
100308	Red
100309	Yellow



Drums



OilSafe drums are fully interchangeable with OilSafe lids. The drums have an extra wide neck opening for rapid pouring and easy cleaning.

Part nr.	Size drum
101001	1.5 liter drum
101002	2.0 liter drum
101003	3.0 liter drum
101005	5.0 liter drum
101010	10.0 liter drum

Hoses



Flexible spout hose attachments for awkward or hard to reach areas. Stumpy hose extension fits the stumpy spout lids. The stretch hose extension fits the stretch and mini spout lids.

Part nr.	Type hose
102020	Stretch extension hose
102021	Stumpy extension hose

Pumps



The standard pump will handle up to ISO 460 fluids. Delivers 1 liter for approx. 12 strokes. Match with utility lid and a 3, 5 or 10 liter OilSafe drum. Handle up to ISO 682. The premium pump is a heavy duty, color coded discharge pump with fully serviceable internals for maximum life.

Part nr.	Color
102000	Standard pump
102030	Pump reducer nozzle
Premium pumps:	
102300	Beige
102301	Black
102302	Blue
102303	Dk Green
102304	Gray
102305	Mid Green
102306	Orange
102307	Purple
102308	Red
100309	Yellow

Fully interchangeable drums and lids. Any style lid works with any size drum.

OilSafe down stroke pump delivers 1 liter for approx. 12 strokes.

Quick twist spout easy to open and close. Controls flow and keeps dirt out.

Push button auto-shutoff air intake enables secure pouring of lubricants

Robust lid design for easier handling

Pre-fill drums and safely store lubricants with OilSafe storage lids

See thru drums with graduated markings make it easy to see and measure liquid levels.

Bright colors make OilSafe dispensers easy to find and easy to color code lubricant grades.



Main dimensions

	Diameter (d)		Width		Height (h)		Outlet diameter (o)		Weight	
	mm	Inch	mm	Inch	mm	Inch	mm	Inch	Gram	Ounce
1.5 Liter Drum	158	6,2			178	7	120	4,7	320	11,2
2 Liter Drum	160	6,3			220	8,7	120	4,7	325	11,5
3 Liter Drum	160	6,3			269	10,6	120	4,7	400	14,1
5 Liter Drum	196	7,7			271	10,7	120	4,7	440	15,5
10 Liter Drum	252	9,9			348	13,7	120	4,7	860	30,3
Storage lid	147	5,8			105	4,1			240	8,5
Utility lid	147	5,8			121	4,8	48	1,9	240	8,5
Mini-spout lid	147	5,8	320	12,6	192	7,6	7	0,3	400	14,1
Stumpy spout lid	147	5,8	322	12,7	210	8,3	25	1	440	14,1
Stretch spout lid	147	5,8	390	15,4	235	9,3	12	0,5	440	14,1

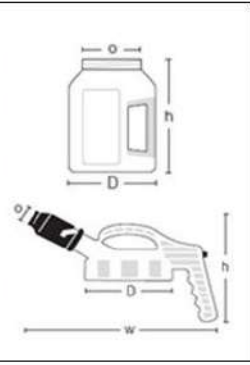

	Length		Hose diameter		Outlet diameter (o)		Weight	
	mm	Inch	mm	Inch	mm	Inch	Gram	Ounce
Pump	440	17,3						
- Hose	1500	59,1			12	0,5	855	33,7
- Reducer	37,5	1,5						
Stretch-spout-hose-extension	305	12	19	0,7	12	0,5	70	2,5
Stumpy-sput-hose-extension	265	10,4	33	1,3	22,5	0,9	130	4,6

Technical Information

Materials	
Drums and lids	HDPE*
Hoses (nozzle, plug, connector and ring)	HDPE
Pump hose	PVC group 2
Pump nozzle	Aluminium
Pump extension sleeve	HDPE
Pump shaft	Mild steel
Pump body	Nylon polyamide PA6
Pump cylinder	Zinc plated mild steel
Service temperature	-40 to 80 °C
Additives	UV stabilizer, antistayic additive
Sealing components	Nitrile (Buma N)

Note:

Contact with strong Oxiding acids (e.g. Ozone, Hydrogen, Peroxide, Halogen etc.) should be avoided.
Not suitable for solvents or fuels.

