



SECURITY



Gas detector in compact format

GasStick - USB gas detector

- Warns of propane/butane gas (LPG) & narcotic gases
- Easy installation via USB port in vehicle
- Very low power consumption:

Standby: 20 mA / Alarm: 22 mA

Extra-compact USB gas stick. Reliably warns of propane, butane gas (LPG) & anesthetic gas thanks to extremely high-quality & small MEMS technology (Micro-Electro-Mechanical Systems). W/ device status LED. 70 dB loud acoustic warning signal. Thanks to its minimalist design, suitable for most power sources w/ a USB connection. Insensitive to temperature fluctuations & humidity.

Dims.: LxWxH app. 7.7 x 28 x 10 mm.

80267

81,70

12V

PROPAN
BUTAN
(LPG)

NAR-
COSE
GASES

USB

MEMS-
TECHNO-
LOGY



With cap



Integrated
Status LED



GasCubeTwin

Reliably warns of propane/butane gas (LPG) & anesthetic gases. Connection options for 2 optional additional sensors. They detect gas concentration in the air just as effectively as main sensor & offer additional safety in case of rising & falling gases. Cable length: 2.7 m. There are 3 possible combinations of additional sensors:

1. 2x sensor for detection of CO gas (carbon monoxide)
2. 2x sensor for detection of LPG gas/narcotic gas
3. 1x Sensor CO gas + 1x sensor LPG gas/Anesthetic gas Color: Matt anthracite

802483

76,30

- ① Additional CO gas sensor (Carbon monoxide) 802484 32,60
- ② Additional sensor propane/butane gas (LPG) 802485 32,70

12V

PROPAN
BUTAN
(LPG)

NAR-
COSE
GASES

OPTICAL
WARNING

ACOUS-
TIC
WARNING

CONNE-
CTION
FOR 2
SENSORS



KONIG
KUNDE
AWARD 2022

3. PLATZ
IN DER
ZURÜCK-KATEGORIE
GAS-WARNSYSTEM

REISE
MOBIL
Europas kompetente
Fachzeitschrift

Connection diagram GasCubeTwin

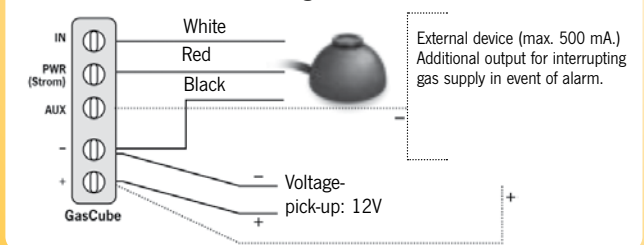

① CO gas-
Sensor



② LPG gas-
Sensor

Complete GPS tracking systems.....	406
Wireless alarm systems.....	407 – 409
Gas alarms & smoke detectors.....	410 – 412
Door locks.....	413 – 418

Safes/vaults.....	419 – 421
Marten protection.....	422
Safety on the road.....	423 – 424
Fire extinguishers/warning signs.....	425

NEW
2024

4G variant now also available for e.g. Switzerland

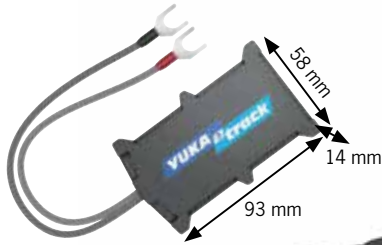

Connection to Vehicle battery

Delivery without mobile

Data flat rate throughout Europe



GPS tracking complete set easyWire for direct connection to vehicle battery

- Position acquisition via GPS and GLONASS
- Precise, worldwide real-time vehicle location via GPS
- Easy installation directly to vehicle battery (10-32 V)
- Includes SIM card and Europe-wide 12 months data flat rate after which renewal is subject to charge via app
- No contract commitment, no hidden additional costs
- Free YUKA@track app for all iOS and Android smartphones
- Integrated rechargeable battery (3.7V, 45 mAh) for short-term mobile use

GPS tracking box including SIM card & free app. YUKA@track - all in one package! Suitable for cars, motorhomes, vans & trucks. List of countries & available languages: Albania, Austria, Bosnia and Herzegovina, Bulgaria, Croatia, Cyprus, Czech Republic, Denmark, Estonia, Finland, France, Germany, Greece, Hungary, Ireland, Italy, Latvia, Lithuania, Luxembourg, Malta, Macedonia, Montenegro, Netherlands, Norway, Poland, Portugal, Romania, Serbia, Slovakia, Slovenia, Spain, Sweden, Switzerland, Turkey, UK.

Technical data: Nano SIM, Memory: 128 MB internal flash memory, Integrated battery: 3.7 V/45 mAh, EU data flat rate for 12 months. (Current costs for contract renewal can be found in app or at www.yukatrack.com)

Scope of delivery: 1x YUKA@track GPS Tracker incl. SIM card w/ data flat rate (12 months) in Europe, 1x Quick Start Guide.

2G variant	47056	130,-
4G variant (e.g. for Switzerland)	47057	239,-



Connection via OBD2 interface of vehicle

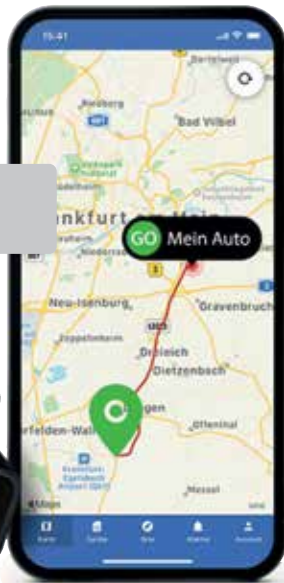

Delivery without mobile

Data flat rate throughout Europe



2G GPS locating complete set with on-board diagnostic interface (OBD2)

- Position acquisition via GPS and GLONASS
- Precise, worldwide real-time vehicle location via GPS
- Easy installation via OBD2 interface of vehicle
- Power supply: 10-32 V
- Includes SIM card and Europe-wide 12 months data flat rate, after which renewal is subject to charge via app
- No contract commitment, no hidden additional costs
- Free YUKA@track app for all iOS and Android smartphones
- Integrated rechargeable battery (3.7V, 45 mAh) for short-term mobile use

GPS tracking box including SIM card & free app.

YUKA@track - all in one package! Suitable for car, camper, van and truck.

List of countries and available languages: Albania, Austria, Bosnia and Herzegovina, Bulgaria, Croatia, Cyprus, Czech Republic, Denmark, Estonia, Finland, France, Germany, Greece, Hungary, Ireland, Italy, Latvia, Lithuania, Luxembourg, Malta, Macedonia, Montenegro, Netherlands, Norway, Poland, Portugal, Romania, Serbia, Slovakia, Slovenia, Spain, Sweden, Switzerland, Turkey, UK.

Technical data: Nano SIM, Memory: 128 MB internal flash memory, Integrated battery: 3.7V, 45 mAh, EU data flat rate for 12 months. (Current costs for contract renewal can be found in the app or at www.yukatrack.com)

Scope of delivery: 1x YUKA@track OBS2 GPS Tracker including SIM card with 12 months data flat rate in Europe, 1x Quick Start Guide.

2G OBD variant	47054	130,-
-----------------------	--------------	--------------



Download here free
Download YUKA@track App
for iOS & Android:



CAN bus radio alarm system for Volkswagen Transporter 6.1/6, Fiat Ducato, Volkswagen Crafter/MAN TGE

- Easy installation through vehicle-specific basic alarm kits
- No complex cabling required thanks to wireless sensors
- Combine optional wireless sensors, up to 55 sensors can be connected

The basic alarm kits are optimally matched to respective vehicle type. Combine basic alarm kit with up to 55 wireless alarm sensors as required. Sensors send permanent radio signal to CAN bus adapter and thus ensure constant vehicle monitoring. Operate the alarm system with remote control of your original vehicle key or via the optionally available radio remote control. Secure windows, doors and storage flaps of your motorhome or camper with the optional wireless alarm sensors.

Download assembly instructions here

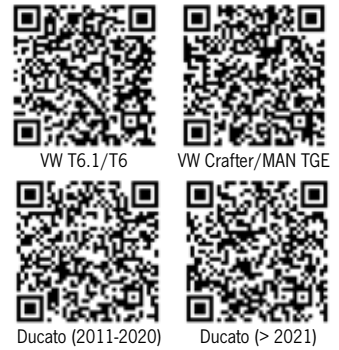

Vehicle-specific CAN bus basic alarm kits

- For Volkswagen Transporter 6.1/6, Volkswagen Crafter/MAN TGE, Fiat Ducato
 - Can be combined with up to 55 wireless alarm sensors (optionally available)
- Technical data:** Power supply: 12V, frequency: 433.92 MHz, current consumption w/ alarm on <15mA, operating temp. -30° C - +70° C, volume 118 dB.
- Scope of delivery:** CAN bus basic alarm kit, vehicle-specific cable set, siren, mounting material, operating instructions.
- Mounting:** External siren is mounted in the engine compartment using a vehicle-specific bracket. Basic alarm kit is mounted in the dashboard, wiring is connected to existing vehicle cables (in different places).

Volkswagen Transporter 6.1/6 >2015	47491	217,-
For Fiat Ducato / Citroën Jumper / Peugeot Boxer / Iveco Daily >2011	47490	228,-
For Volkswagen Crafter / MAN TGE >2017	47492	228,-

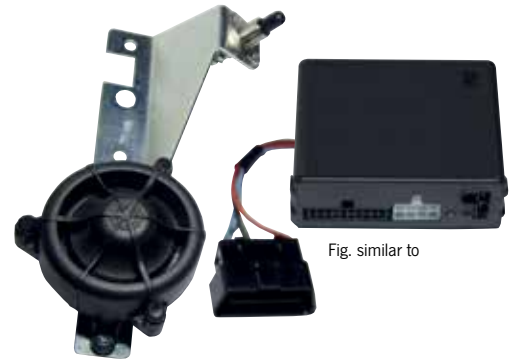

Wireless Combine wireless sensors as required

Wireless window sensor for motorhome windows

- ① **wireless tilt sensor** especially for hinged windows. Unobtrusive, no visual disturbance. The one-piece sensor is simply glued to window pane. Compact size LxWxH: 42 x 30 x 13 mm. **47499 69,80**
- ② **Wireless window sensor w/ integrated pressure switch** No counter contact required thanks to pressure switch tec. Incl. 3 adapter plates to mount on windows from Dometic, Polyplast & other manufacturers. The adapter plate is screwed to window frame. Scope of delivery: Wireless window sensor, 3 adapter plates, Battery, mounting acc. **47482 56,30**



Wireless magnetic contact for Protection of doors, barn doors, roof hatches or windows

Radio magnetic contact is screwed to flap/door and frame. 2-piece incl. batteries and mounting acc. **47481 56,30**



360° RadiInfraredIndoor sensor

- Sufficient for all living space monitoring for vans and small motorhomes w/o need for additional sensors
 - Suitable for ceiling mounting, very compact and hardly visible
- PIR technology (Passive Infrared Sensor): Sensors register infrared radiation or heat emitted by objects. When a sharp increase in room temperature is perceived, the system triggers alarm. **47483 76,30**



Wireless motion sensor/ anti-theft sensor

- Attached to objects outside vehicle (e.g. bicycle). If object is moved, main alarm unit is triggered.
 - Concealed mounting possible
- 47484 72,40**



Radio remote control

- For activating/deactivating alarm system w/ multiple users
- 47485 56,30**





WiPro III + WiPro III safe.lock
CAN bus radio alarm systems for motorhomes

- Simple, intuitive handling: vehicle locked/alarm armed
- Radio magnetic contacts without cable!
- Staying in the vehicle possible w/o deactivating sensors
- Control of control panel via vehicle radio key and radio hand-held transmitter
- Easy add 2.0: Subsequent coupling of radio acc via radio handheld transmitter or car doors
- Up to 100 radio modules can be coupled
- Up to 75 meters radio range (free field)
- Copy-proof thanks to over 4 billion codes
- Jammer detection "anti-jamming"
- Remote alerting & locating w/ Pro-finder (opt.)



Technical data:

Consumption app. 11 mA, power supply 12/24 V, alarm tone app. 102 dB Weight control panel: app. 90 g, dim. control panel (W x H x D): 80 x 80 x 29 mm

Scope of delivery:

WiPro III or WiPro III safe.lock control panel, status LED, wireless hand-held transmitter 868, wireless magnetic contact black 868, wiring harness, installation material, warning sticker, manual

WiPro III safe.lock

For VW T6.1, Citroën Jumper, Peugeot Boxer, VW Crafter II, MAN TGE, Fiat Ducato, Mercedes Sprinter VS30, Iveco Daily >2006, Opel Movano >2021.

	470904	523,-
For Ford Transit from model year . 2019 Switch lock can be activated in vehicle	470914	523,-

WiPro III

For Ford Transit from 2006+	470901	468,-
For Mercedes-Benz Sprinter from 2006+ Mercedes-Benz Vito from 2014+ VW Crafter from 2006+ MAN TGE from 2017+	470902	523,-
For VW T5 2003 - 2015 VW T6 from 2015+ Renault Master from 2003+ as well as vehicles without CAN bus and other models	470903	468,-

Download THITRONIK® App now!

- ✓ Arming/disarming your alarm system Locking/unlocking*
- ✓ Locating vehicle with GPS**
- ✓ Teach-in mode for radio modules ...and many more functions

Download on the **App Store** | GET IT ON **Google Play**

* only in conjunction w/ WiPro III safe.lock & BLUETOOTH® networking module or Pro-finder
 **only in conjunction w/ Pro-finder

Acc. for WiPro III + WiPro III safe.lock + WiPro easy:



- | | | |
|--|--|--|
| <p>① NFC module
 NFC module serves as virtual key for arming/disarming your alarm system using transponder card or with NFC tag accessory (key fob), the wristband or a compatible credit card. The perfect control solution for WiPro III, WiPro III safe.lock and WiPro easy. WiPro III safe.lock owners can also access their central locking system and unlock/lock their vehicle without a key. Scope of delivery: NFC module, batteries, transponder card. 470920 183,-
 KeyCard (transponder card) 470921 20,80
 KeyTag (tag) 470922 20,80
 KeyStrap (silicone wrist strap) size M, color black 470923 27,30
 Size L, color black 470924 27,30</p> | <p>② Radio hand-held transmitter 868
 470909 75,30</p> <p>③ Radio magnetic contact 868: Self-adhesive radio magnetic contact w/ tamper protection for securing windows, doors, storage flaps, roof boxes, roof hatches, etc.
 Black 470993 75,30
 White 470930 75,30</p> <p>④ Radio cable loop 868: Secures your mobile goods outside the vehicle. Radio cable loop alarms in case of cutting or sabotage.
 White, length 2.5 m 47089 99,20
 Weiß, Length 5.0 m 470900 106,-
 Black, length 2.5 m 47083 99,20
 Schwarz, Length 5.0 m 47084 106,-</p> | <p>⑤ Radio gas detector 868: For connection to 12/24 V. Reports narcotic gas attacks and gas leaks (propane/butane) by radio. 47096 137,-</p> <p>⑥ Auxiliary siren, 12V 80222 42,60
 Ext. back up siren, 12V, battery buffered.
 Warns in case of power supply failure or sabotage. (w/o. Fig.) 80219 53,50</p> <p>⑦ Mounting adapter: For optimal mounting of radio magnetic contacts on door seals of storage flaps.
 White 472269 18,60
 Black 472262 18,60</p> |
|--|--|--|

WiPro easy - wireless alarm system for caravan owners & self-builders



- Easy installation with proven Thitronik safety standard
- Radio magnetic contact included (1 piece)
- Expandable by up to 8 radio components
- Operation via radio remote control & NFC module
- Audible warning with 105 dB volume

The 12V alarm system is easy to install & offers proven THITRONIK® security standard. With included wireless handheld transmitter, alarm system can be armed/disarmed & panic alarm can be triggered. Wireless magnetic contact is included in scope of delivery. Siren w/ 105 dB volume & panic alarm function. System can be expanded by up to 8 add. wireless components, incl. new NFC module (see pg. 408). Scope of delivery: WiPro easy control panel, radio hand-held transmitter 868 (loud/silent), Radio magnetic contact 868 black, siren, status LED, connection cable, quick guide, installation material, warning sticker. Technical data: Power supply: 12 Volt, current consumption: 6mA, alarm sound: 105 dB, temp. range: -20 °C - +80 °C (central unit), dim.: 55 x 28 x 56mm (W x H x D), weight: 177g **470911 326,-**



Ideal for Caravan owner and self builders

Networking module for WiPro III

- Controlling the WiPro III via Bluetooth®
- Control central locking via smartwatch/mobile (only in conjunction with WiPro III safe.lock)
- Easy add 3.0: Subsequent pairing of wireless accessories via app

Module couples mobile w/ WiPro III alarm system via app and Bluetooth in vicinity of motorhome, authorized user can conveniently arm or disarm system at any time. With a WiPro III safe.lock, which also accesses the existing central locking system, vehicle can be opened & closed w/o vehicle key or hand-held transmitter. Networking module can also be integrated if Pro-finder locating system is already installed.

Technical data: Nominal voltage: 12/24 V, BLUETOOTH® 5.0 low energy, temp. range: -20 °C - +80 °C, radio range (free field): app. 10 m Operating voltage: 12/24 V, dim.: (WxHxD) 52 x 25 x 56 mm, weight: 72 g. **470910 141,-**



Compatible with the Thitronik app
[Google play](#) [Download on the App Store](#)

Pro-finder: Locating solution for WiPro III / WiPro III safe.lock & as "stand alone" locating system



- For remote immobilization of vehicle in combination w/ shut-down device
- Receive alarm messages via SMS or phone call
- Locate stolen vehicle
- Can also be used w/o alarm system
- Remotely control alarm system via SMS or call
- Geofencing (virtual fence) through WiPro
- Easy add 3.0: Subsequent pairing of wireless acc. via app
- SMS costs only incurred in emergency (SIM card must be SMS, telephony and data-capable)
- Integrated GPS receiver & GSM antenna
- Voltage monitoring
- Special caravan mode
- Load switch-off in event of deep discharge, battery monitoring w/ undervoltage alarm

Technical data: Power supply: 12/24 volts, current consumption transmit: app. 37 mA, current consumption stand-by: app. 16 - 21 mA, nr. of destination nrs.: up to 10, interface: RJ10 (input for WiPro), outputs: 2x open collector (max. 0.5A), weight: app. 129 g, temp. range: -10 °C - +80 °C, dims.: (WxHxD) 125 x 27 x 135 mm **472176 523,-**



Compatible with the Thitronik app
[Google play](#) [Download on the App Store](#)

Accessories for Pro-finder:

- ① **Switch-off device**
For decommissioning the vehicle. **80259 38,20**
- ③ **GSM antenna (2m cable):** Provides a secure mobile phone connection in areas with poor reception. Is screwed to antenna socket instead of rod antenna. **472178 72,-**
- ④ **GPS-pro (external GPS)**
Used when internal GPS receiver of Pro-finder is covered by metal parts e.g., and therefore has no reception. Cable length: 2 m **472177 141,-**





GBA-I

- Detects KO/Anesthetic Gas, Propane & Butane
- Integrated sensor and buzzer
- Operation also on 230 V (optional)
- Automatic sensor self test
- Temperature compensation
- E1 Type approval



Technical data: Power supply: 12/24 volts, current consumption: app. 70 mA, sensitivity: 50 ppm, sound pressure: 85 dB (internal siren), temp. range: -20 °C - +80 °C, dim.: 38 x 100 x 27 mm (W x H x D), weight: 60 g

	80235	119,-
Power supply 230V f. GBA-I	80237	31,70
Universalanschlusskabel f. GBA-I	80236	28,40



G.A.S. plug "all in one"

- Detects KO/narcotic gases, propane & butane
- Integrated sensor and buzzer
- Operation in cigarette lighter
- Automatic sensor self test
- Temperature compensation
- E1 Type approval



Technical data: Current consumption: app. 70 mA, Sensitivity: from 50 ppm, Alarm tone: app. 85 dB (int. Siren), temperature range: -20 °C to +80 °C
Scope of delivery: GAS-plug, manual, alarm sticker

80200	106,-
--------------	--------------

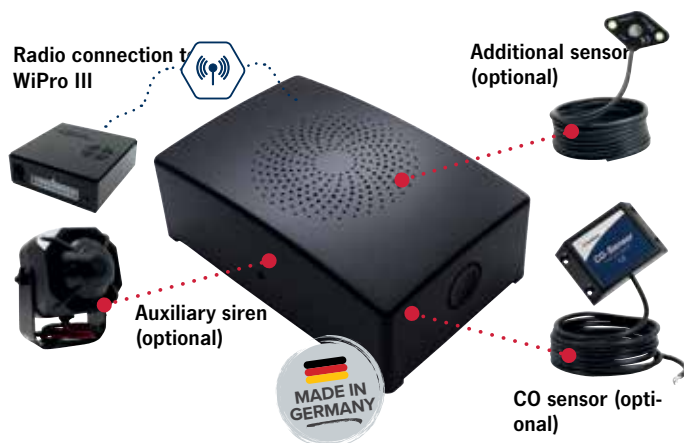

- Gas detection according DIN EN 50194-2
- Gas detection according DIN EN 50291-2 (CO version)
- CI bus capable
- Detects propane & butane, anesthetic gases or Carbon monoxide (depending on equipment)
- Permanent compensation of temperature and humidity
- Internal siren 94 dB
- Regular self-test to determine functionality
- Alarmoutput/siren output
- Auto Sense Input
- LED display for both sensors

Thitronik G.A.S.-pro III - CI bus capable



The G.A.S.-pro III is a modular gas warning system for permanent installation in your vehicle & reliably warns you of gas poisoning & narcotic gas attacks, w/ integrated siren & radio unit. The G.A.S.-pro III is available in two basic setups: w/ integrated liquid gas/stun gas sensor or w/ integrated CO sensor. Both variants can be combined with an additional gas or CO sensor. Internal siren sounds at a piercing 94 dB, and an integrated humidity sensor optimizes the already precise measurement in the event of high humidity in vehicle or breathing air in direct vicinity of sensor. Precise temperature adjustment is mandatory. In addition, an alcohol filter function eliminates false alarms caused by alcohol in air. Thanks to integrated radio unit, the G.A.S.-pro III communicates w/ the WiPro III alarm system without additional wiring.

Technical data:
 Power supply: 12/24 volts, current consumption: 9 mA (CO)/26 mA (liquid/CO gas), sensor inputs: 1 internal, 1 external, sensitivity: 50 ppm (CO) 700/1400 ppm (butane), sound pressure: 94 db (internal siren), temp. range: -20°C - +60 °C, dim.: (W x H x D): 61 x 97 x 35 mm, weight: 74 g.

G.A.S.-pro III - CO(carbon monoxide)	80256	305,-
Co-sensor	80223	108,-
Additional sensor	80257	70,90
Auxiliary siren	80222	42,60



Thitronik G.A.S.-pro



- Detects KO/narcotic gases, Propane & butane
- Carbon monoxide sensor (optional)
- Concealed mounting possible
- External sensors for optimal placement
- Up to 3 sensors connectable
- Siren and alarm output
- Service-friendly, plug-in sensors
- Connection for external LED (operation indicator)
- Automatic sensor self test
- E1 Type approval

Technical data:
 Power supply: 12/24 volts, current consumption: app. 80 mA per sensor, 3 sensor inputs, sensitivity: from 50 ppm, sound pressure: app. 85 dB (int. Beeper) app. 110 dB (ext. Siren), temperature range: -20 °C to +80 °C, dim. (W x H x D): 100x90x40 mm, weight: 140 g

Scope of delivery:
 Control panel, sensor for anesthetic gases (propane & butane), mounting material, manual & alarm sticker

G.A.S.-pro	80220	174,-
Zusatzsensor	80221	70,90
CO sensor	80223	108,-
Auxiliary siren	80222	42,60
Back up siren	80219	53,50
External LED , as operating indicator for concealed mounting of the G.A.S.-pro control panel.	802201	16,40



Please note installation of gas detectors.

Anesthetic gases are lighter than air, so mount sensors slightly above sleeping height.
 Butane/propane gas & carbon monoxide (CO) is heavier than air, so mount sensors slightly below sleeping height.



① **GasStick - USB gas detector**

- Warns of propane/butane gas (LPG) & narcotic gases
 - Easy installation via USB port in the vehicle
 - Very low power consumption: Standby: 20 mA / Alarm: 22 mA
- The extra-compact GasStick is supplied w/ power via a USB port (USB 2.0) in vehicle & reliably warns of propane, butane gas (LPG) & narcotic gas thanks to extremely high-quality & small MEMS technology (Micro-Electro-Mechanical Systems). An integrated LED indicates the device status. Acoustic warning signal: app. 70 dB. Minimalist design & uncomplicated installation make the GasStick a mobile gas detector for most energy sources with a USB connection. Insensitive to temperature fluctuations & humidity. Dim.: LxWxH approx. 77 x 28 x 10 mm.

80267 81,70

② **GasCube - Gas detector in noble design**

- Warns of propane/butane gas (LPG) & narcotic gases
 - Visual & audible indication of operational readiness, calibration phase and alarm
- Fixed connection to 12 V on-board power supply. Pressure switch. Ready for operation after app. 3 min. With high sensitivity sensor & 80 dB loud siren. Temperature-controlled sensor that works reliably even above 25°C. Power consumption in standby: 100 mA, power consumption in alarm: 180 mA. Mounting: about 100 cm above the ground. Dim.: 55.6 x 86.7 x 24 mm.

Color: Matte white 802482 70,80

③ Counter display w/ 10x GasCube matt white 802480 690,-

④ **GasCubeTwin**

Equipment identical to above mentioned GasCube, but w/ connection possibilities for 2 opt. additional sensors. Detect gas concentration in air just as effectively as main sensor & offer additional safety in case of rising & falling gases. Cable length is 2.7 m. There are 3 possible combinations of additional sensors:

1. 2x sensor for detection of CO gas (carbon monoxide)
 2. 2x sensor for detection of LPG gas/narcotic gas
 3. 1x Sensor CO gas + 1x sensor LPG gas/Anesthetic gas
- Color: Matt anthracite 802483 76,30

⑤ Additional sensor CO gas (Carbon monoxide) 802484 32,60

⑥ Additional sensor Propane/Butane Gas (LPG) 802485 32,70

⑦ **LPG gas detector at TOP price**

Reliably warns of gas leaks. Acoustic alarm: 85 dB, installation height for butane/propane gas detection: app. 20 to 40 cm above floor. 12 Volt, power consumption: 100 mA. Temp. range: -10/+50°C. Dim.: 115 x 70 x 60 mm. Scope of delivery: LPG gas detector, mounting material.

80216 32,70

⑧ **2 in 1 combi gas detector**

- Recognizes natural gas / LPG / CO gas
 - 2 integrated sensors
 - Self-test function, audible and visual alarm
 - Includes wall bracket for easy installation
- Operating voltage: 12 volts, temp. range: -10°C ~ +50°C
Alarm volume: 85 dB, Power consumption: Standby 90 mA / with alarm 120 mA, Dim.: 125x80x40 mm 802180 43,50

⑨ **Smoke detector with battery operation**

- Monitoring area < 6m height: 60 m²
 - Battery operation with 9 V block battery
 - With test button for function test
- Alarm as sound & light signal, alarm volume: 85 dB, dim.: Ø 130x40 mm. Including ceiling bracket for screwing on.

80300 27,20





12V

Gas Detector "BMTG"

12 V LPG & narcotic gas warner

Reliably and quickly detects LPG and narcotic gas and triggers an audible alarm (85 dB) even at low gas concentrations. Also fits into mounting frame "Berker Integro". The average life of the sensor is 10 years. Voltage 12 V DC, consumption: 75mA. Audible alarm signal app. 85 dB. Supplied w/ mounting frame. Dim. 119 x 60 mm.

Grey 802030 116,-
Brown 802040 116,-



12V

Gas Detector "BMTCO"

12 V carbon monoxide detector, warns of exhaust fumes in vehicle

Reliably & quickly detects carbon monoxide & triggers an audible alarm (85 dB) even at low gas concentrations. Also fits into mounting frame "Berker Integro". Voltage 12 V DC; Consumption: 15mA. Acoustic signal at alarm app. 85 dB. Supplied w/ mounting frame. Dim. 119 x 60 mm.

Grey 802050 160,-
Brown 802060 160,-



TriGas alarm

for propane/butane/KO gas

- Warns about anesthetic gases
- Visual and audible indication of operational readiness, calibration phase and alarm

Fixed connection directly to body battery. Pressure switch. Ready for operation after app. 1 min. With high-sensitivity sensor & app. 80 dB loud siren.

The TriGas Alarm checks function of sensor each time it is switched on & automatically calibrates itself to ambient air & temperature. Intelligent electronics carries out following steps every 40 sec. performs calibration check & adjusts it if necessary.

TriGas alarm has temp. control & compensates for differences so that detection of dangerous gases also works reliably at temperatures above 25°C.

LED display: Green (flashing) = calibration phase, Green (continuous) = everything OK, Red (flashing) = 20 sec. Pre-alarm w/o sound, red (continuous) = alarm +

continuous alarm sound (approx. 80 dB)
80247 119,-

Optional additional sensor (not shown)
Placed 10 cm below ceiling)

802470 53,50



12V



GAS ALARM P100

- Type tested for motorhomes, caravans & dwellings
- With sensor for liquid gas (butane/propane) & town gas/natural gas (methane)
- Immediately warns of gas leakage, long before dangerous gas concentration in air is formed
- Loud alarm sound and red alarm light
- Green operation indicator & self-test function
- Easy mounting (wall mounting)
- Operation at 230 volts with additional power supply unit (acc.)

P100, w/ switching output 12 V DC, which can be used to activate additional devices such as fans, alarm system, GSM module & other signal transmitters

751411 109,-

Response thresholds:

Methane (town gas/natural gas) 0.4000 vol
Butane (liquefied gas) 0.2050 % by volume
Propane (liquefied gas) 0.2400 Vol. %

Technical data:

Operating voltage: 12 V DC (-10% / +20%)
Current consumption: max. 250 mA
Alarm volume: 85 dB (A) / 1 m
Dimensions: 60 x 90 x 31 mm (W x H x D)



12V



AMS Gas Combination Alarm Device Compact

- Ideal for use in caravans, motorhomes or truck cabs with small volume of space
- Warns about liquid gas & anesthetic gas
- For detection of propane, butane, methane gases & anesthetic gas (KO gas holdup)
- Dangerous anesthetic gases are detected even at lowest concentrations, well before they develop their anesthetic effect
- Low power consumption in normal operation of app. 90 mA, 12 V

Response thresholds:

Butane app. 0.4 % / propane app. 0.5 % / methane app. 0.8 % / anesthetic gas from app. 100 ppm.

Display: LED yellow = start-up phase / LED green = operating display / LED red = (3 x) for alarm message, Acoustic warning signal via electric siren w/ a volume of 85dB (A)
Dim.: W 115 x H 90 x D 30 mm.

80210 140,-





Security locks for cab doors

- High-quality finish in anodized aluminium 2017
- Drill-proof core for additional strength
- Stainless steel screws
- Developed & manufactured in Europe



Fiat Ducato 8 > 09/21 For panel vans & motorhomes, installation on inside of cab doors. Left and right keyed alike. Dim.: L165 x W155 x D65 mm, weight: app. 1 kg. Scope of delivery: 2x lock w/ mounting material & 3 keys.

464353 222,-



Fiat Ducato 2006-2021 For panel vans & motorhomes, installation on inside of cab doors. Left and right keyed alike. Dim.: L180 x W165 x D45 mm, weight: app. 0.9 kg. Scope of delivery: 2x lock with mounting hardware & 3 keys.

464354 211,-



Universal surface-mounted lock for sliding & rear doors Can be fitted to camper vans & vans. Dim.: L180 x W165 x D45 mm, weight: app. 1 kg. Scope of delivery: 2x lock with mounting material & 3 keys, incl. mounting template.

464355 232,-



UniversalLock for body doors External locking w/ key, locking & unlocking from inside via rotary lever. Mounting possible on all motorhomes & caravans. For mounting the rotary lever, there must be a distance of min. 16 mm inside next to door. Dim.: L250 x B140 x D50 mm, weight: app. 1 kg. Scope of delivery: 1x lock with mounting material & 2 keys.

464350 138,-



Universal Built-in lock for Luggage compartment flaps Can be fitted to all motorhomes & caravans. Dim.: L250 x B140 x D50 mm, weight: app. 0.8 kg. Scope of delivery: 1x lock with mounting material & 2 keys, incl. mounting template.

464352 125,-



Universal surface-mounted lock for luggage compartment flaps Can be fitted to all motorhomes & caravans. Dim.: L250 x B140 x D50 mm, weight: app. 0.8 kg. Scope of delivery: 1x lock with mounting material & 2 keys.

464351 101,-

SECURITY LOCKS FOR PANEL VANS AND MOTORHOMES



- HEOSafe®-locks provide additional theft protection
- Easy operation, one handle to lock/unlock the door
- Easy installation in the armrest or on door frame
- Robust & light due to die-cast aluminum
- Individual parts assembled with spring pressure system (prevents rattling or vibrating)
- Special security cylinder w/ protective cap & robust reversible key



HEOSafe® -VAN Security for security of sliding, rear & hinged doors for VANs / panel vans



Also for Ducato 8 from YOC. 9/21

Van security package Fiat Ducato, Boxer, Jumper, keyed alike Consisting of 2 locks for interior cab doors and 2 exterior locks for sliding door and rear doors.

White, for YOC. until 09/21	467404	368,-
White, for model year from 09/21 (Ducato 8)	467415	368,-
Black, for YOC. until 09/21	467408	368,-
Black, for model year from 09/21 (Ducato 8)	467417	368,-

Van Security Package MB Sprinter keyed alike



Consisting of 2 locks for cab doors inside & 2 exterior locks for sliding door & rear doors.

White, from YOC. 2018	467412	368,-
Black, from model year . 2018	467413	368,-

HEOSafe® set Carado / Sunlight

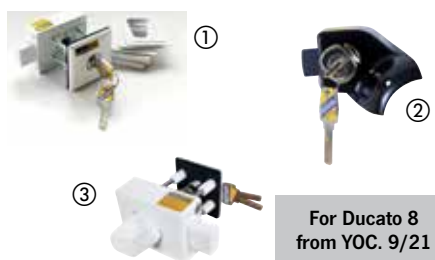

For Ducato 8 from YOC. 9/21

- ① HEOSafe® 1958 additional lock
- ② HEOSafe® 12656/12856 for Ducato cab door
- ③ HEOSafe® 1951 additional lock Carado/Sunlight

Carado/Sunlight Sets motorhomes

keyed alike

Set w/ 12856+1951+2 x 1958 for YOC. from 09/21 (Ducato 8)	464413	577,-
---	---------------	--------------

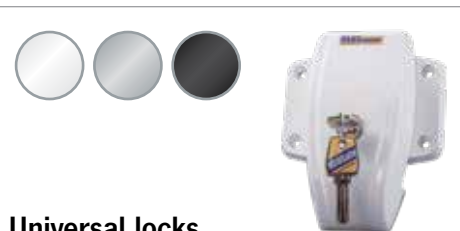

Universal locks Van Security for panel van

• For sliding, rear and hinged doors

Single lock		
1760 White	467401	108,-
1760 Grey/Silver	467409	108,-
1760 Black	467410	108,-
set of 2, keyed alike		
1760-2 White	467403	216,-
1760-2 Grey/Silver	467411	216,-
1760-2 Black	4674031	216,-



HEOSafe® interior fuse

• For sliding door Fiat Ducato 250/290 from YOC. 2006, Citroën Jumper/Peugeot Boxer

Secures sliding door when you are in vehicle. Material: Aluminum die casting

1763	464411	97,10
------	---------------	--------------

HEOSafe® -Additional locks for body doors, rear garages, flaps ...



Universal additional lock

Especially for body doors, exterior flaps, rear garages of motor homes, caravans. For door thicknesses from 20 - 90 mm. Scope of delivery: lock incl. 5 spacers (3x 2 mm + 2x 8 mm thickness)

Single lock		
1958 White	467532	119,-
Sets, keyed alike Set of 2		
1958-2	467422	238,-
3er-Set 1958-3	467533	351,-



Mounting accessories for additional lock 1958

Facilitates installation of additional locks on body doors w/ interior trim.

120118 Color white, adjustable up to 11 cm.	467428	30,50
120134 Farbe schwarz, Specially for body doors from Corado/Sunlight >2024	467429	38,10



Door Frame Lock for body doors

• For body doors, rear garages, flaps on motorhome or caravan

Single lock		
1750 White	467402	119,-
set of 2, keyed alike		
1750-2 White	467425	216,-

Fiat Ducato / Peugeot Boxer / Citroen Jumper / Opel Movano (>2021)



Also for Ducato 8 from YOC. 9/21

Also for Ducato 8 from YOC. 9/21

Fiat Ducato 250/290, P. Boxer, C. Jumper from YOC. 2006, 1 pair

Mounting: integrated in armrest

① Rotary lock			
12646 For YOC. until 09/21	467433	148,-	
12846 Für Bj. from 09/21 DUCATO 8	467430	148,-	
② With key			
12656 For YOC. until 09/21	467432	174,-	
12856 Für Bj. from 09/21 DUCATO 8	467439	174,-	

HEOSystem sets (1-key system):

keyed alike

The set consists of 2 locks for cab doors inside and 1 or 3 additional locks for the body door or flaps/rear garage.

Set from 12656 + 1958, for YOC. 2006 until 09/21	467434	288,-	
Set with 12856 + 1958 for YOC. from 09/21 (Ducato 8)	467444	288,-	
Set with 12656 + 3x 1958, for Bj. 2006 until 09/21	467436	516,-	
Set with 12856 + 3x 1958 for YOC. from 09/21 (Ducato 8)	467445	516,-	

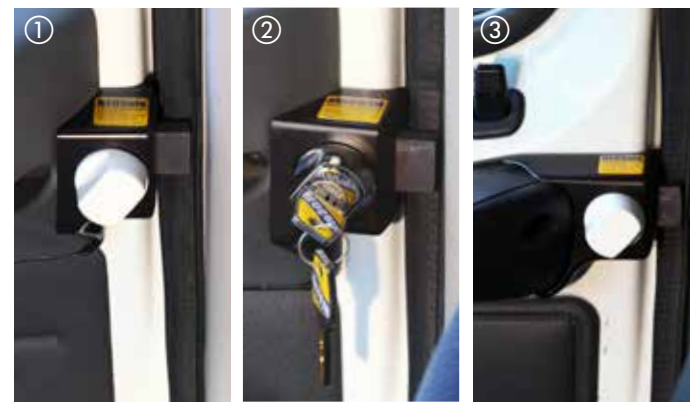

Fiat Ducato 244, P. Boxer, C. Jumper Bj. 2002-2006, 1 pair

Mounting: w/ existing screws on door handle

① 12146 Rotary lock	46741	141,-	
② 12156 With key	46742	174,-	

Fiat Ducato 230, P. Boxer, C. Jumper Bj. 1994-2002, 1 pair

Installation: w/ existing screws on door handle

③ 1246 Rotary lock	46796	108,-	
③ 1256 With key	46797	141,-	

Renault Master / Opel Movano (<2021) / Iveco Daily / Nissan NV400 / Ford Transit

Renault Master, Opel Movano, Nissan NV400 from YOC. 2010, Iveco Daily from YOC. 2014, 1 pair

Mounting: On inside of the door frame

① 15146 Rotary lock	45717	148,-	
② 15156 With key	457171	174,-	

Renault Master, Opel Movano Bj. 2000-2010, Iveco Daily Bj. 2000-2014, 1 pair

Mounting: On inside of the door frame

① 1546 Rotary lock	46751	148,-	
② 1556 With key	467511	174,-	

Ford Transit, 1 pair

Mounting: On inside of door frame

YOC. 2000-2006

① 1446 Rotary lock	46787	148,-	
② 1456 With key	46788	174,-	

YOC. 2006-2013

① 14146 Rotary lock	467871	148,-	
② 14156 w/ key	467881	174,-	

From YOC. 2014

① 14646 Rotary lock	467883	148,-	
② 14656 With key	467882	174,-	



HEOSystem sets (1-key system):

Ford Transit Sets (from YOC. 2014)

keyed alike

Set consists of 2 locks for cab doors inside and 1 or 3 additional locks for the body door or flaps / rear garage.

Set with 14656 + 1958	467885	288,-	
Set with 14656 + 3x 1958	467886	516,-	

Mercedes-Benz Sprinter / Volkswagen Crafter



MB Sprinter from YOC. 2018

Mounting: on inside of the door frame, 1 pair

① 13846 Rotary lock	467420	148,-	
② 13856 With key	467421	174,-	

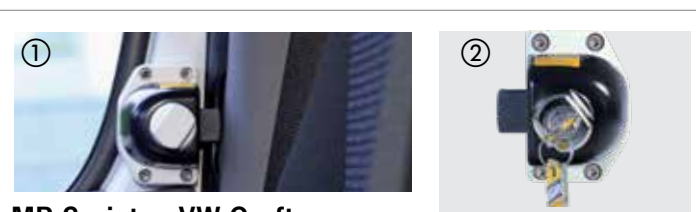

MB Sprinter, VW Crafter

YOC. 2006-2018

Mounting: on inside of the door frame, 1 pair

① 13146 Rotary lock	467981	148,-	
② 13156 With key	467991	174,-	

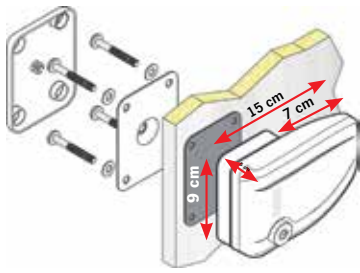

from **79,20**



Safe Door Security locks

The proven Safe Door locks have been further improved. A new lock, new lock cover design w/ asymmetrical fixing point for easier replacement of security keys in event of loss.

① Safe Door exterior door security

Fuse for motorhome doors. Also suitable for drawbar boxes, garage doors.

1 piece	White	467462	79,20
1 piece	Grey	467463	83,90
1 piece	Black	467464	83,90
set of 3	White	467454	228,-
set of 3	Grey	467455	238,-
set of 3	Black	467456	238,-

② Safe Door Frame body door lock

For doors & flaps. Mounting on aluminum door or flap profile, with 3 self-tapping screws. Necessary for vehicles that have no space for a counter plate to the left of the door.

1 piece	White	467485	82,60
1 piece	Grey	467486	86,20
1 piece	Black	467487	86,20
set of 3	White	467492	235,-
set of 3	Grey	467493	246,-
set of 3	Black	467494	246,-

③ Safe Door Magnum external security

A total length of 20 cm to also cover the lock of motorhome door. Attached to the wall w/ four through screws & inner counter plate.

1 piece	White	467495	94,90
---------	-------	--------	-------

④ Safe Door Magnum Frame body door lock

A total length of 20 cm to also cover lock of motorhome door. Mounting on aluminum door profil or garage profil w/ three self-tapping screws.

1 piece	White	467496	97,10
---------	-------	--------	-------

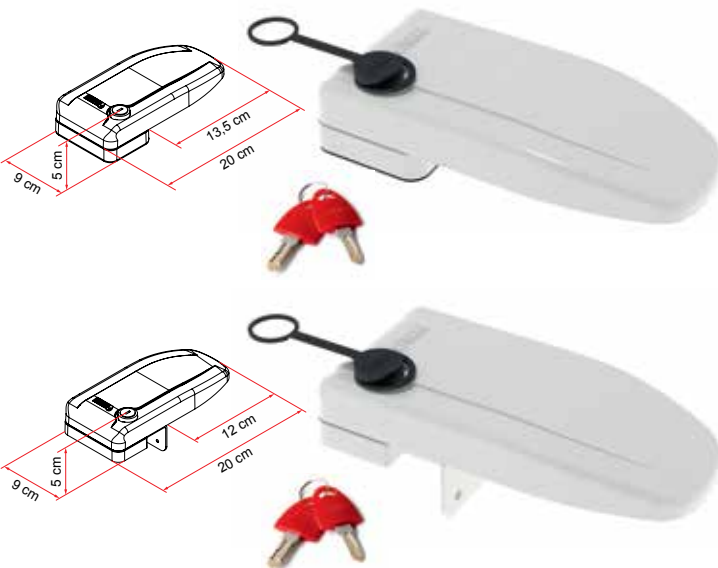
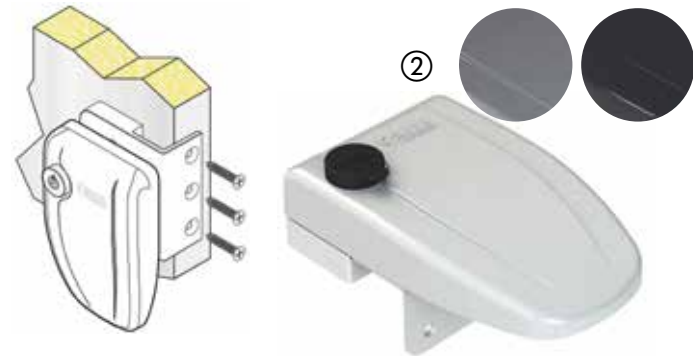

Go on excursions w/ peace of mind - thanks to increased safety

① Safety bar

Robust safety bar to block front doors of motorhome. Transport size: 123.5 x 18.5 cm. For Sprinter, Ducato, Boxer, Jumper, Master until 6/06
46734 75,30

② Interior door lock Safe Door Guardian

Security block w/ is placed inside door or garage of mobile homes & caravans or cab doors. Replaces the stock locks in their position using the same holes. Die cast aluminum, no plastic parts.

Kit consisting of 2 pieces:

Safe Door Guardian (2 pcs. in set)	46790	68,70
For Ford Transit until YOC. 06/2000	46738	88,20
For Ford Transit from YOC. 06/2000	467381	79,30
For Fiat Ducato until YOC. 09/2009	467382	83,90
For Fiat Ducato from YOC. 09/2009	467383	85,-



SafeDoor® Guardian

Fig. shows 46790

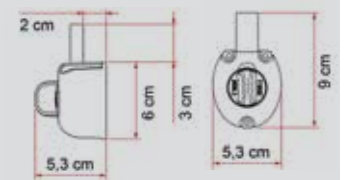

Further dimensional drawings available w/ this QR code



Door security & entry aid Security 31/46 cm high

① Entry aid & door safety device Security 31 or 46

For motorhome & caravan doors. Folded over the door, protects against theft. Boarding aid when getting off and on. With sturdy padlock. Door hinge optionally left or right.

Scope of delivery: Bracket, lock, security bolt, mounting bracket, screws & inner counter plate. Color white.

Security 31 Hanger 31cm high	91236	130,-
Security 46 hanger 46cm high for 2-part entrance doors	91237	151,-

② Additional lock for kit Security Lock 31/46

Additional security lock for the entrance door. For retrofitting existing Security 31 or 46 door locks. Complete w/ lock & internal counter support.

912373 62,20

③ Entry aid and door security Security 46 Pro

46 cm high with additional lock. Additional anti-theft protection when entrance door is closed.

Scope of delivery: Bracket, safety lock for door, safety bolt, mounting bracket, screws & inner counter plate.

912372 196,-



Security 46 Pro with additional Lock for still more security



80,70

Thule Door Lock

- Suitable for doors, rear garages & service hatches

Additional, robust door lock. Permanently connected to vehicle wall w/ sturdy counter plate, seal and 4 M6 screws.

45710	80,70
set of 3, keyed alike	45712 232,-



Thule Door Frame Lock

- Suitable for doors, rear garages & service hatches

Door interlock when inner mounting position (counter plate) is covered by furniture/not possible. Minimum door gap (5 mm) required.

45711	80,70
set of 3, keyed alike	45713 232,-



closed

open

Thule Van Lock

Safety lock for van rear and sliding doors. Suitable for all van models.

45715	107,-
set of 2, keyed alike	45716 203,-



closed

open

Thule Cab Lock

To secure vehicle doors from the inside w/ a key. Suitable for Fiat Ducato and Ford Transit. (Adapter for Mercedes Sprinter & Renault Master on request).

45714	155,-
set of 2, keyed alike	



Thule Security Handrail

Entry aid and door protection for motorhomes and caravans, for right and left hinged doors. Aluminum white, weight app. 2 kg

45720	151,-
-------	-------



245

70

100

24

122 123 (overlap) 16

39

13

Thule Inside-Out Lock G2

For securing body doors on motorhomes & caravans, Interior and exterior.

45721	135,-
-------	-------

Inconspicuous storage of valuables

- Perfect hiding place for cash, jewelry, etc.
- High quality & precisely produced according to original products
- Invisible twist locks, effortless to open
- Perfect for vacation, travel & home

Tin value depot: The lid can be easily opened using an invisible twist lock. The splash-proof can has a volume of 850 g. Ø 100 mm, height 120 mm. Weight: 123 g.

- | | | |
|---|--------|-------|
| ① Erasco lentil stew | 474731 | 15,20 |
| ② Erasco Chicken Rice Pot | 474741 | 15,20 |
|
 | | |
| ③ Screwdriver | | |
| Handle can be screwed on effortlessly. Can be used as a real screwdriver. Length app. 18 cm. | 47470 | 15,20 |
| ④ M6 screw: Made from a real M6 screw. Ø 15 mm, length: 105 mm. | 47477 | 24,80 |
|
 | | |
| ⑤ Ballistol Universal Oil | | |
| Corresponds to an original Ballistol can. Base of can can be opened using invisible screw cap. Ø 65 mm, height: 240 mm. Weight 156g | 47476 | 21,80 |
|
 | | |
| ⑥ Safe can San Pellegrino Orange | | |
| Inconspicuous: made from real beverage can (0.33 l). The weight is also amazingly close to a filled can. Recessed safe container with 100 ml capacity, splash-proof. Dimensions: app. H 11.5 x Ø 6 cm | 474712 | 20,70 |



Safety - Transportable Safety cassette

- Safety cassette incl. holder
- Including safety rope
- With 2 keys
- Compact installation dims.

Safety can be quickly inserted or removed at any time thanks to supplied, firmly screwed mount. Cassette is firmly connected to holder by means of a lock tongue. Dim.: holder app. W16 x D22 x H7 cm, cassette app. W15 x D21.5 x H6 cm. Weight: 1.7 kg. Scope of delivery: Safebox, holder, 2 keys, security chain, mounting material.

47132 27,20

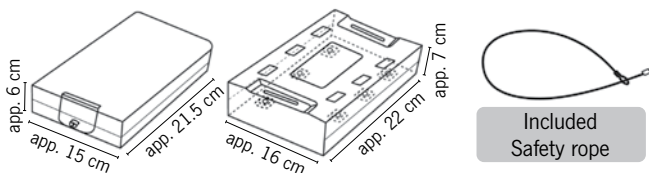

Rex - Versatile Furniture safe

- Solid steel body and door
- Double bolt locking (Ø 16 mm)
- Including 2 double-bit keys

Secure your valuables such as jewelry, cash & documents in your motor-home, caravan, office or yacht. Holes for permanent mounting in cabinet or bookcase. Door hinge on the right w/ concealed hinges. Weight: 6.8 kg. External dim.: app. W31 x D20 x H20 cm. Scope of delivery: safe, 2 keys, fixing material.

47136 54,50

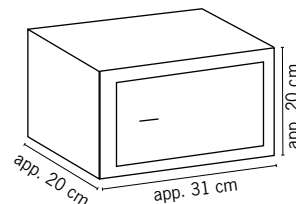



220,-

**Volkswagen Transporter
6.1/6/5/4**

Fits exactly under passenger seat console. Two installation options: 1. Door opening from footwell of front seats. 2. Operation from passenger compartment. Fastening via existing screw units of seat consoles. External dim. W 25 x H 13 x D 33 cm. Door clearance dim. 22.4 x 10.4 cm. Weight. app. 9.0 kg **471344 220,-**



**Volkswagen Crafter /
MAN TGE > 2017**

For installation in seat console on driver or passenger side. Mounting w/ original screw connection of console.

Dim. product: W 32 x H 12.5 x D 36 cm
Weight: app. 9.3 kg

For rear door: Access to safe via rear of console. **471331 274,-**

For door in front: Access to safe via front of console. **471332 274,-**



Iveco Daily

For installation in seat console on driver or passenger side. Mounting with original screw connection of console.

Dim product: W 22 x H 14 x D 40 cm
Weight: app. 7.8 kg **471330 250,-**



Mercedes-Benz Sprinter >2019

Mounting is done by means of robust screws in standard opening and holes in seat console. Modifications or additional holes on the seat bracket are not necessary. For all vehicles with opening size 9.5x20 cm in the console. Outer dim.: WxDxH 200x95x300 mm. Door clearance dim.: WxH 200x95 mm, weight: app. 3.0 kg **471333 250,-**



Fiat Ducato

Fastening via screw connections of seat bracket. Loosen front screw connections of console, place socket safe underneath, tighten screws – done!

For type 244/X250 2001-2006 External dim. W 28 x H 18 x D 26 cm, weight. app. 9.0 kg. **471342 218,-**

For type X250 + 290 >2006. External dim. W 28 x H 18 x D 35 cm, Weight app. 11 kg. **471343 260,-**

Laptop version for type X250 + X290 >6/2006, for 17" Laptop
Driver or passenger side. External dim. (WxHxD) 28 x 18 x 45 cm, weight app. 14.0 kg. **471347 367,-**



Mobile safe size 3 A - top door

Outer dim. W 30 x H 16 x D 40 cm, door clearance 36 x 26 cm. 4 holes in bottom for fixed mounting. Weight app. 12 kg **471441 290,-**



Standard Safe G3 - Top door

Outer dims. W 25 x H 13 x D 22 cm, door clearance dim. 22.4 x 19.4 cm. 4 holes in bottom for fixed mounting. Weight app. 6.5 kg. **471421 181,-**



**Standard Safe G5
suitable for 17 inch laptop**

Door on top w/ sturdy handle. Supplied with 2 base plates, lock, handle & bottom padding. When dismantled, base plates remain on the floor & the loading space can be fully utilized. External dim.: W 50 x H 18 x D 36 cm. Weight app. 19 kg. **47142 348,-**



Mobile safe ADRIA

Suitable for almost all common Adria vehicles w/ floor storage compartment. Door on top with spring handle. Delivery includes mounting hardware. External dims.: W 40 x H 14 x D 38 cm. Weight app. 9.0 kg
471410 311,-



**Mobile safe for Globecar/Pössl 2010
Door oben, with spring handle**

Outer dims. W 37 x H 14 x D 49 cm, door clearance 33 x 45 cm. 4 holes in bottom for fixed mounting. Weight app. 14 kg
471442 317,-



202,-

Insert safe for Volkswagen California Coast and Ocean

Suitable for models Coast, Coast 30 Years reflex silver metallic, Coast 30 Years indium gray metallic, Coast Edition, Ocean, Ocean Edition & Ocean gray/red/blue. Installation is located in cabinet at rear left. Fastening via existing holes in cabinet. Material: 5 mm SM steel impact & scratch resistant powder coating. Dims. (WxDxH): 320 x 400 x 60 mm Weight: app. 5.8 kg
471400 202,-



**NEW
2024**

Safe seat base for Volkswagen Grand California

Developed to fit the Volkswagen Grand California perfectly. Safe is bolted to driver's or passenger's seat console using the original fastening screws. No holes need to be drilled. Dims. (WxDxH): 260x380x125 mm Weight: app. 8 kg
Front door
 (to be opened in direction of passenger footwell)
471401 272,-
Rear door
 (opens towards the living room)
471402 272,-



Door safe for Fiat Ducato

Can be mounted on driver or passenger door of original Fiat cab doors from YOC '06 (type x 250 and x 290). Original attachment points of the map pocket located there are used for this purpose. Provides space for a 15-inch notebook. Secured with 3-bolt locks.

2006 - 08/2019
 Dims. H 330 x W 550 x D 140 mm, weight app. 7.0 kg. **471346 352,-**
09/2019 - 09/2021
 Dim. H 525 x W135 x D 325 mm, weight app. 8.0 kg. **471348 352,-**
>09/2021 (only for passenger door)
 Dims. H 265 x W100 x D 115 mm, weight app. 4.2 kg. **471349 272,-**

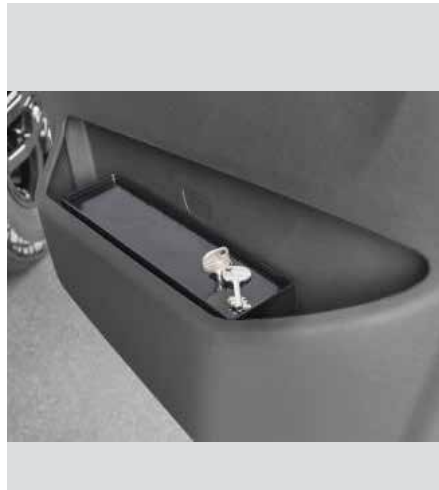

Door safe for Ford Transit > 06/'19 (passenger side)

Specially developed for passenger door of Ford Transit from YOC 06/2019. Safe is mounted in door compartment w/ a mounting plate that can be locked and is not visible from the outside. Lid is protected from prying because there are no attachment points. Safe is equipped with a 3-bolt lock with 7 tumblers. External dims: WxHxD 275x70x165 mm, weight: app. 3.5 kg.

471350 272,-



Punch protection plate for Eurochassis door handles Fiat Ducato, Citroën Jumper, Peugeot Boxer >'06

The stab protection plate is mounted between the door handle and the vehicle body. Suitable for driver, passenger door and sliding and rear door. Prevents lock mechanism from being levered open under door handle (e.g. with a screwdriver). Made of robust stainless steel, precisely fitting the contour of the handle shell modeled. Fastening via the mounting holes of recessed grip, no separate holes in the door necessary.

47010 37,-

MARDEN PROTECTION

Marten STOP&GO secures your car, house & yard from pesky martens -
Over 30 years of defense experience with innovative solutions



Scent Mark Remover Special Cleaning Foam - For Pretreatment

- Well adherent effect foam
- Simplest handling
- Harmless for electronics, plastic, rubber & paint

Strongly recommended before any marten repellent measure!
Removes scent mark of the marten. This means that a risky engine wash can be avoided. When engine is cold, spray entire engine compartment and inside of hood and fenders with entire contents and allow to react briefly. Simply rinse with water.

Spray can, 300 ml

903945

11,90



Danger
H222, H229

AntiMarten spray Intensive active ingredient - fragrance concentrate*

- Long-term effect, lasts up to 2 years
- Monthly scale for marking the next re-spraying date

Marten repellent for spraying. Concentrate w/ long-term effect, smells "dangerous enemy" for marten. Spot, regular application to enclosed self-adhesive "scent stores" is sufficient.

Spray can, 200 ml

9039452

20,60



Danger
H222, H229

2-speaker ultrasound machine

- 2 waterproof piezo speakers
- Ultrasound w/ frequency modulation
- Simplest installation (ready wired)
- On-board power supply, maintenance-free
- Function indicator light, flashing or steady LED
- CAN data bus suitable, E1 marking of the KBA

With 12 V on-board power supply. Frequency-modulated ultrasonic sounds that signal "maximum danger" to marten through animal cries of fear and warning. Avoidance of sound shadows due to two loudspeakers. Ideal for narrow & compactly installed engine compartments. Note: Ultrasound does not penetrate matter. **Technical data:** Radius of radiation: 360°, Angle of radiation: 2 x 160°, Sound pressure: app. 105 dB

9039453

124,-



STOP&GO Accessories:

Mounting bracket:

- For all STOP&GO marten repellent devices
- Simplified installation of all STOP&GO devices
- Mounting of marten repellent device in Engine compartment w/ only one screw
- Individual alignment of ultrasound
- Mounting material included

9039459

10,60

High temperature protection hose

- Inner diameter 12,50 mm
 - Packed in shipping tube of 4 x 0.50
- Universal glass fabric aluflex hose for cables on catalytic converter, lambda probe & soot particle filter. Extremely heat-resistant protective hose, effectively shields heat from up to 800 °C hot radiation sources, w/o internal heat build-up.

9039457

36,-

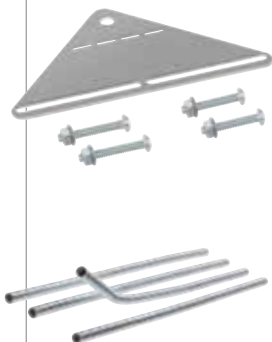

Fragrance disc - Intensive active ingredient - fragrance concentrate*

- Effective for at least 6 months
- Tab for expiration date
- Can be stored unopened for app. 3 years
- Without mounting

Scent disc with long-term effect, smells "dangerous enemy" for the marten. The simple fastening device with practical hook allows individual attachment. Can be used in car, house, garden or carport. Large evaporation surface provides intense release of fragrance. With only one fragrance disc it is possible to protect the entire engine compartment. Effective for at least six months.

Danger: H317, H319

9039451

18,50



Attention

4B battery ultrasonic device

- Operation w/ batteries
- Term up to 24 months
- 2 waterproof piezo speakers
- Super slim design
- Frequency modulation against habituation
- Function control lamp, flashing LED
- Waterproof according to IP65, E1 marking of the KBA

Highly effective ultrasonic device w/ battery operation. Frequency-modulated ultrasonic sounds that signal "maximum danger" to marten through animal cries of fear & warning. No habituation effect.

Independent of on-board power supply due to operation w/ two 3-volt button cells (CR2477), long runtime of app. 24 months per battery set. Ideal for long-term parkers like classic cars, motor homes, exhibition vehicles or for carport. **Technical data:** Radius of radiation: 360°, Angle of radiation: > 170°, Sound pressure: app. 110 dB

9039454

87,10



High voltage unit with ultrasound - With six PLUS-MINUS CLIP stainless steel contact plates

- Sensor technology
- 12 Volt connection or battery operation
- 2 waterproof piezo speakers (IP65)
- Frequency modulation against habituation
- Function control lamp, flashing LED
- Stainless steel contact plates in super flat slimline design
- E1 marking of the KBA

Clip fastening option of double-pole stainless steel contact plates facilitates installation & offers even more flexibility, especially for increasingly compact engine compartments. Connection to terminal 15 is omitted due to sensor technology. Thanks to a contact slide attached directly to the unit, the installation of a hood contact switch is also unnecessary.

Technical data: Radius of radiation: 360°, Angle of radiation: > 170°, Sound pressure: app. 110 dB

7 PLUS-MINUS CLIP, with 12 V connection 9039455

256,-

8 PLUS-MINUS CLIP, with battery operation 903946

265,-



Protection against martens by ultrasonic sounds

**Marten-Free Plus
(12 V power supply)**

Effective and permanent protection against marten bites app. 80 dB sound pressure, 12-23 kHz frequency in intervals. With function control LED. 12 V DC, protection class IP 54,
903943 22,90



**Marten-Free Mobile
(battery-operated)**

app. 80 dB sound pressure, 23 kHz frequency in interval. Effective radius app. 40 square meters. With function control LED Battery operation, 6x AAA/Micro (not incl.).
903944 34,90



CARBEST



Tailgate opener - ventilation despite locking

- Close & lock the tailgate except for ventilation gap
- Tailgate can no longer be opened from outside in this state
- Easy to install, no tools required
- Made of solid, powder-coated metal

Suitable for following vehicles: Volkswagen Caddy (2003-2020), Volkswagen Transporter 6/5/4, Mercedes Benz Vito (> 2003), Mercedes-Benz Viano (2003-2014), Ford Tourneo Custom (> 2013).

46309 21,80



① Flat tire kit

Driving w/ max. 80 km/h to next workshop possible. Scope of delivery: 700 ml tire sealant gel, mini compressor 12 volt, valve opener with acc. & storage bag. **47404 72,40**

② Spare bottle of tire sealant gel, 700 ml Fits above tire puncture kit **474061 32,60**

Blind spot warning sign

Warning sign has been mandatory in France for motorhomes, caravans & trailers from 3.5 t since 2021. 3 stickers are required per vehicle.

- Self-adhesive**, Dims.: 25 x 17 cm **46383 4,35**
- Magnetic**, Dimensions: 24.8 x 17 cm **46385 10,90**

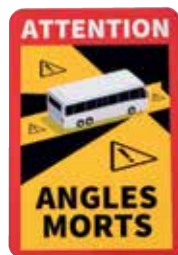

CARBEST

Steel wheel claw

Wheel claw for wheels up to 26.5 cm wide. Scope of delivery incl. 2 keys. Dims.: app. 23 x 50 cm, weight: app. 2.3 kg

913401 41,40



Further anti-theft devices can be found on page 383.

Safety/instructionsticker

- ① Distribution block 6-fold** Dims. app. W45 x H100 mm. **75132 5,15**
- ② Gas kitchen appliances** Dims. app. W85 x H30 mm. **75146 1,10**
- ③ Close window during heating operation** Dims. app. W50 x H25 mm. **75145 1,10**
- ④ Check roof lock** Dims. app. W53 x H30 mm. **99565 1,35**
- ⑤ Gasoline only** Dims. app. W50 x H50 mm. **600921 1,65**
- ⑤ Drinking water** info sign **60090 1,10**
- ⑥ Diesel** Dims. app. W90 x H30 mm. **60092 1,10**



For more signs and warning stickers please scan the QR code.





Europe Sticker set, 6 pieces

Set of transparent base sticker (app. W60 x H50 cm) w/ country outlines & pre-cut country fills in 5 colors w/ printed country names.

Europe sticker set **46438** **35,50**



QR code scan and Product video view



LIFEHAMMER®
Multifunctional Emergency hammer

- Easily shatters car windows
- Integrated belt knife
- Non-slip handle
- Incl. Quick Click clamp mount for car door

Simply press emergency hammer against vehicle's windshield & ultra-hard ceramic hammer head will automatically shatter the glass. Integrated belt knife. Easy and safe to use by adults & children thanks to non-slip handle. TÜV certified according to new German standards. The Quick Click holder allows you to attach emergency hammer to the inside of the vehicle door.

47540 **19,70**



Countries Flag stickers

- pack of 2
- Dims.: 145 x 125 mm

Germany	464302	3,75
Finland	464305	3,75
Sweden	464303	3,75
Norway	464304	3,75



ReservedSign

For motorhomes & caravans, so that your campsite is not occupied by others. Dims.: 61.5 x 30 cm

47085 **27,20**

27,20



CARFirst-aid bag

For motor vehicles. Content according to DIN & legal requirement of StVZO § 35h. Includes 2 disposable medical masks.

47127 **14,40**

Incl. 2 disposable medical masks

Image similar



① **High visibility vest orange for Italy**

Vest according to EU DIN standard EN 471. Universal size.

471281 **4,80**



② **High visibility vest yellow for Spain and Portugal**

Color also approved in Italy. Otherwise like 471281.

471282 **4,80**

CARBEST



High visibility vest set Family

4-piece, 1 x XXL, 1 x XL (EN ISO 20471: 2013), 2 x Universal (EN 1150: 1999) incl. practical protective bag.

471285 **13,10**



Safety First!

Fire extinguishers for cars, camper vans, motorhomes & caravans

Fire extinguisher

- ① **Fire extinguisher 1kg**
with pressure gauge, extinguishing powder: ABC. With wall bracket. Tested according to DIN-EN3, ideal for vans.
47154 27,20
- ② **Fire extinguisher 2kg**
with pressure gauge, extinguishing powder: ABC. With wall bracket. Tested according to DIN-EN3. Ideal for caravans and motorhomes.
471540 42,40
- ③ **Fire extinguisher 6kg**
with pressure gauge & hose, extinguishing powder: ABC. With wall mount. Tested according to DIN-EN3. Ideal for permanent campers.
471541 64,40



Innovative Fire protection

- Maintenance-free
- Easy operation
- Glows in the dark

Intuitive to operate in case of fire. Tested according to EN 3-7. Extinguishes app. 35 sec. long. Extinguishing agent 99.5% biodegradable & environmentally friendly.

Fire classes:
5A: Wood, paper, textiles, etc.
21B: Gasoline, diesel, wax, etc.
5F: Frying oil, frying fat, etc. Suitable for electrical equipment up to 1000 V & 2 L bio-ethanol gel fires.

471543 43,50



Suitable holder

Robust plastic bracket for mounting on wall or in vehicle

471544 15,-

Warning triangle

Ready for use in just a few seconds and quickly folded up again to save space. Approved throughout Europe. High stability due to long metal feet. Stowed in convenient storage box.

47128 11,50

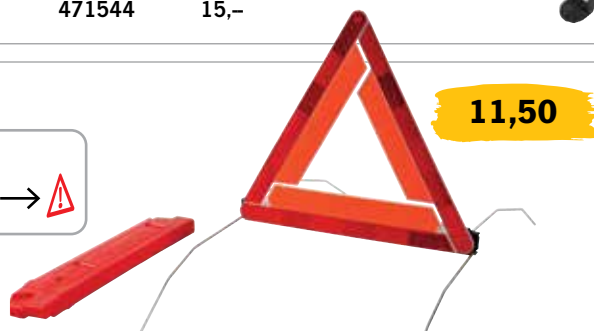

11,50



Incl. Reflectors

Plastic warning sign 50 x 50 cm
Light plastic version w/ four reflectors. Area not reflecting. For protruding loads. Mandatory in many European countries. Not approved for Italy and Spain.

47116 13,30



Aluminum warning sign for Spain
For bike racks and extra long loads. Three stripes. Reflective surface. 50 x 50 cm Easy to attach.

471171 32,60



Aluminum warning sign for Italy
For bike racks and extra long loads. Five stripes. Reflective surface. Easy to install. 50 x 50 cm.

47117 34,30

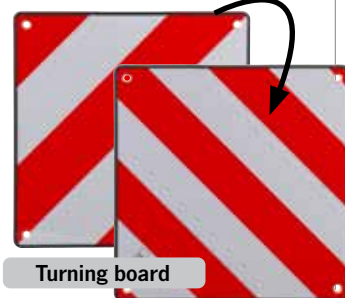

Turning board



Aluminum reversible warning sign for Spain & Italy
For bicycle carriers & extra-long loads. Reflective surface. Easy to install. Material: aluminum, 50 x 50 cm.

471174 45,80